

vtech[®]
baby

Parent's Guide

3-in-1 Snuggle & Cuddle Lovey™



INTRODUCTION

Thank you for purchasing the **3-in-1 Snuggle & Cuddle Lovely™**. This versatile fawn transforms from a lovey blanket and pacifier holder into a cuddly friend. Cuddle and teethe with the included leaf teether toy. Explore soft plush and multiple textures while listening to soothing nature sounds and music.

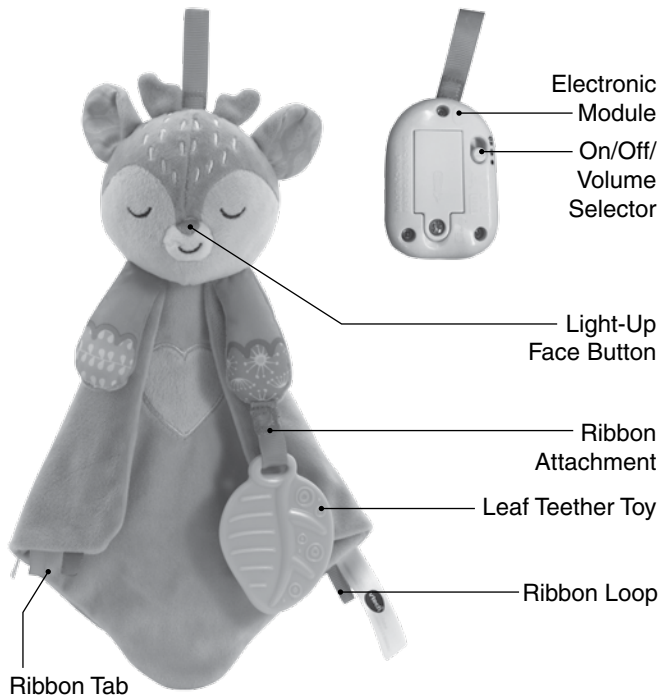

INCLUDED IN THIS PACKAGE

- 3-in-1 Snuggle & Cuddle Lovey™
- Leaf teether toy
- Parent's guide

WARNING

All packing materials, such as tape, plastic sheets, packaging locks, removable tags, cable ties, cords and packaging screws are not part of this toy, and should be discarded for your child's safety.

NOTE

Please keep this parent's guide as it contains important information.

ATTENTION

Pour la sécurité de votre enfant, débarrassez-vous de tous les produits d'emballage tels que rubans adhésifs, feuilles de plastique, attaches, étiquettes et vis d'emballage. Ils ne font pas partie du jouet.

NOTE

Il est conseillé de conserver ce guide des parents car il comporte des informations importantes.

GETTING STARTED

Battery Removal and Installation

1. Make sure the unit is turned **Off**.
2. Find the battery cover on the back of the **Electronic Module** inside the fawn. Use a screwdriver to loosen the screw and then open the battery cover.
3. Remove old batteries by pulling up on the side of each button cell battery.
4. Install 3 new LR44 batteries following the diagram inside the battery box.
5. Replace the battery cover and tighten the screw to secure.

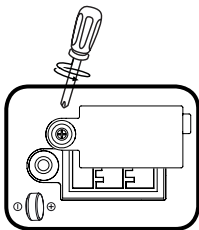

WARNING:

This product contains a button or coin cell battery. If swallowed, a button or coin cell battery can cause internal chemical burns in as little as two hours and can lead to death. Dispose of used batteries immediately. Keep new and used batteries away from children. If you think batteries might have been swallowed or placed inside any part of the body, seek immediate medical attention, and go straight to the nearest hospital emergency department.

ATTENTION :

Ce jouet contient une pile bouton ! L'ingestion d'une pile bouton peut causer des brûlures internes pouvant provoquer la mort dans un délai de 2 heures. Jeter les piles usées immédiatement après les avoir retirées du jouet. Garder les piles neuves hors d'atteinte des enfants. Si vous remarquez qu'une pile bouton a été avalée, consultez immédiatement un médecin.

Australia/New Zealand:

If you suspect your child has swallowed or placed a button cell / coin battery inside any part of their body, immediately call the 24-hour Poisons Information Centre on 13 11 26 (in Australia) or 24-hour National Poisons Centre on 0800 764 766 (in New Zealand) for fast, expert advice and go straight to the nearest hospital emergency room.

BATTERY NOTICE

- Use three LR44 alkaline button cell batteries only for this toy.
- The button cell batteries used with this product should be kept away from small children who might still put things in their mouths. If the button cell battery is swallowed, consult a doctor immediately.
- Insert the button cell batteries with the correct polarity (+ and -).
- Do not use damaged button cell batteries.
- Do not short-circuit the button cell battery terminals.

- Remove the exhausted battery cell battery from the toy.
- Remove the button cell batteries during long periods of non-use.
- Do not dispose of button cell batteries in fire.
- Do not charge a non-rechargeable button cell battery.
- Do not mix old and new batteries.
- Do not mix different types of batteries: alkaline or standard (silver oxide).

MISE EN GARDE

- Utiliser uniquement 3 piles boutons LR44 pour ce jouet.
- Les piles boutons utilisées avec ce jouet doit être tenue à l'écart des enfants qui pourraient encore porter des choses à la bouche. Si une pile bouton est avalée, il faut consulter immédiatement un médecin.
- Mettre en place les piles boutons en respectant les polarités + et -.
- Ne pas utiliser les piles boutons endommagées.
- Ne pas mettre les bornes des piles boutons en court-circuit (en reliant directement le + et le -).
- Enlever les piles boutons usagées du jouet.
- Retirer les piles boutons en cas de non-utilisation prolongée.
- Ne les jeter ni au feu ni dans la nature.
- Ne pas tenter de recharger les piles boutons non rechargeable.
- Ne pas mélanger des piles boutons neuves avec des usagées.
- Ne pas mélanger des piles alcalines avec des piles à l'oxyde d'argent.

INSTRUCTIONS FOR WASHING

The lovey is machine washable. Please remove the **Electronic Module** from the lovey before cleaning.

1. Open the hook-and-loop closure on the back of the lovey and remove the **Electronic Module**.
2. Follow the care instructions on the plush tag.
3. After washing, re-insert the **Electronic Module** and secure the hook-and-loop closure.

WARNING / ATTENTION :

Adult assembly required for battery installation.

Keep batteries out of reach of children.

Les piles ou accumulateurs doivent être installés par un adulte.

Tenir les piles ou accumulateurs hors de portée des enfants.

CAUTION:



Adult assembly required. For your child's safety, do not let your child play with the toy until it is fully assembled.

ATTENTION !

Ce jouet doit être assemblé par un adulte. Pour la sécurité de votre enfant, ne pas le laisser jouer avec le jouet tant que ce dernier n'est pas complètement assemblé par un adulte.

PRODUCT FEATURES

1. On/Off/Volume Selector

To turn the unit **On**, slide the **On/Off/Volume Selector** located on the **Electronic Module** to the Low  or High volume  position. You will hear a song, a welcoming phrase and sounds. To turn the unit **Off**, slide the **On/Off/Volume Selector** to the **Off**  position.

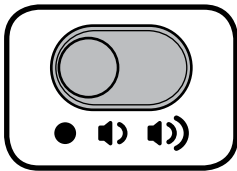

2. Automatic Shut-Off

To preserve battery life, the **3-in-1 Snuggle & Cuddle Lovey™** will automatically shut off after each audio response. The unit can be turned on again by pressing the **Light-Up Face Button**.

NOTE

If the unit powers down or if the light fades out during play, please install a new set of button cell batteries.

ACTIVITIES

1. Light-Up Face Button

Press the fawn's **Light-Up Face Button** to hear a variety of soothing melodies and gentle nature sounds. Press and hold the **Light-Up Face Button** to hear sweet sounds and loving phrases. The light will flash with the voice and fade in and out with the music and sounds.



2. Ribbon Attachment and Teether Toy

Use the included leaf-shaped **Teether Toy** to provide your child with oral sensory stimulation, or attach your own pacifier using the **Ribbon Attachment**.



NOTE

Before using the **Teether Toy** for the first time and after each use, wash with warm soapy water, then rinse. **DO NOT** use boiling water, steam, a microwave or dishwasher to clean the **Teether Toy**.

3. Fold-Up Fawn

Transform the lovey blanket into a plush fawn to cuddle.

Folding Instructions

To change the lovey to a plush toy, please follow these steps:

1. Lay the lovey flat, then fold the bottom point of the square back and in half to form a triangle.

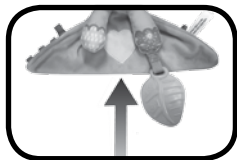

2. Fold the right side in, then fold the left side on top, tucking the arms inside.

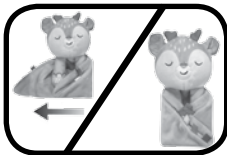

3. Secure the blue **Ribbon Loop** from the right side over the **Ribbon Tab** on the left.

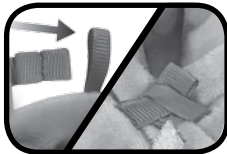

4. Attach the included **Teether Toy** or a pacifier (sold separately) to the **Ribbon Attachment** with the hook-and-loop closure.

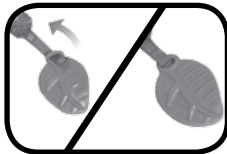

MELODY LIST

1. Toyland
2. Twinkle, Twinkle, Little Star
3. Bicycle Built for Two
4. Cradle Song
5. Sleeping Beauty Waltz
6. Diddle, Diddle Dumpling
7. Für Elise
8. Grandfather's Clock
9. White Coral Bells
10. Good Morning Merry Sunshine
11. London Bridge
12. Hickory, Dickory Dock
13. Listen to the Mockingbird

14. Hey, Diddle, Diddle
15. Irish Lullaby
16. Mary Had a Little Lamb
17. Rock-a-bye Baby
18. Did You Ever See a Lassie?
19. Sailing, Sailing
20. Au Claire de la Lune
21. Home Sweet Home
22. Little Bo Peep
23. Little Miss Muffet
24. Teddy Bears' Picnic
25. Hush, Little Baby

SONG LIST

Song 1

Play time, nap time,
I'm ready for some cuddle time.

Song 2

You and me, together we'll be,
Best friends for ever.
Let's have a great big hug.

Song 3

Twinkle, twinkle, little star,
How I wonder what you are.

CARE & MAINTENANCE

1. Keep the unit clean by wiping it with a slightly damp cloth.
2. Keep the unit out of direct sunlight and away from any direct heat sources.
3. Remove the button cell batteries if the unit will not be in use for an extended period of time.
4. Do not drop the unit on a hard surface and do not expose the unit to excess moisture.

5. The fawn is machine washable. Please remove the **Electronic Module** before cleaning and follow the washing instructions on the tag.

TROUBLESHOOTING

If for some reason the unit stops working or malfunctions, please follow these steps:

1. Please turn the unit **Off**.
2. Interrupt the power supply by removing the batteries.
3. Let the unit sit for a few minutes, then replace the batteries.
4. Turn the unit **On**. The unit should now be ready to play again.
5. If the unit still does not work, install a new set of batteries.

IMPORTANT NOTE:

If the problem persists, please call our **Consumer Services Department** at **1-800-521-2010** in the U.S. or **1-877-352-8697** in Canada, or by going to our website at **vtechkids.com** and filling out our **Contact Us** form located under the **Customer Support** link. Creating and developing **VTech®** products is accompanied by a responsibility that we take very seriously. We make every effort to ensure the accuracy of the information, which forms the value of our products. However, errors sometimes can occur. It is important for you to know that we stand behind our products and encourage you to contact us with any problems and/or suggestions that you might have. A service representative will be happy to help you.

CAUTION

Changes or modifications not expressly approved by the party responsible for compliance could void the user's authority to operate the equipment.

NOTE

This equipment has been tested and found to comply with the limits for a Class B digital device, pursuant to Part 15 of the FCC Rules. These limits are designed to provide reasonable protection against

harmful interference in a residential installation. This equipment generates, uses and can radiate radio frequency energy and, if not installed and used in accordance with the instructions, may cause harmful interference to radio communications. However, there is no guarantee that interference will not occur in a particular installation. If this equipment does cause harmful interference to radio or television reception, which can be determined by turning the equipment off and on, the user is encouraged to try to correct the interference by one or more of the following measures:

- Reorient or relocate the receiving antenna.
- Increase the separation between the equipment and receiver.
- Connect the equipment into an outlet on a circuit different from that to which the receiver is connected.
- Consult the dealer or an experienced radio/TV technician for help.

Supplier's Declaration of Conformity

47 CFR § 2.1077 Compliance Information

Trade Name: VTech®
Model: 5365
Product Name: 3-in-1 Snuggle & Cuddle Lovey™
Responsible Party: VTech Electronics North America, LLC
Address: 1156 W. Shure Drive, Suite 200
Arlington Heights, IL 60004
Website: vtechkids.com

THIS DEVICE COMPLIES WITH PART 15 OF THE FCC RULES. OPERATION IS SUBJECT TO THE FOLLOWING TWO CONDITIONS: (1) THIS DEVICE MAY NOT CAUSE HARMFUL INTERFERENCE, AND (2) THIS DEVICE MUST ACCEPT ANY INTERFERENCE RECEIVED, INCLUDING INTERFERENCE THAT MAY CAUSE UNDESIRE OPERATION.

CAN ICES-3 (B)/NMB-3(B)

**Visit our website for more
information about our products,
downloads, resources and more.**

vtechkids.com
vtechkids.ca

Read our complete warranty policy online at
vtechkids.com/warranty
vtechkids.ca/warranty

